

***FORCE 170 FAST LUXURY YACHT USMH 60 KNOTS***

***UFM Group Engineering***



***NEW DESIGN JMG Force 170 ROYAL POLARIS***



***SENIOR DESIGN SUSSURO UNIT***

**UNIQUE PLEASURE TO CRUISE smoothly AT 50 knots on a 5 stars Palace**



## FORCE 170 Specification Document

<b>Type:</b>	Force 170 RP	<b>Built:</b>	2014
<b>Builder:</b>	UFM/USMH Group Italy	<b>Speed:</b>	Max speed 60 knots Cruising speed 35 knots
<b>Classification:</b>	Rina, AMS yacht services	<b>Flag:</b>	Hong Kong
<b>Engines:</b>	2*MTU 16V 4000 M93L Light Alloy perallumen	<b>Guests:</b>	10 in 5 staterooms
<b>LOA:</b>	51.85m     170'	<b>Crew:</b>	10 Crew in 4 cabins
<b>Beam:</b>	8.5m         27.9'	<b>Made in :</b>	Italy
<b>Draft:</b>	1.9m         5.2'	<b>Price:</b>	\$24 million EURO

**General Characteristics**

**Year Built:** 2014  
**Builder:** UFM Group, Italy  
**Shape :** Special Deep V and anti-slam Bow JMG ShipProect  
**Interior Designer:** Custom interior decoration  
Leonardo ACCIARI

**Length:** 51.85m 170'  
**Beam:** 85m 27.9'  
**Max Draft:** 1.6m 5.2'

**Hull Material:** Light Alloy  
**Super Structure:** Light Alloy

**Guests:** 10  
**Numbers of Cabins:** 5  
**Total Crew:** 8 to 10

**Speed, Range and Consumption**

**Cruising Range:** Without turbine 40 knots range 1500nm  
With turbine 50 knots 1000nm  
**Max Speed:** 60 knot with turbines range 800nm

**Propulsion System:**

**Main Engines:** Twin MTU 16V 4000 M93L (2\*2440kw)  
**Turbine:** Twin Rolls Royce Kamewawaterjet TF50 (2\*2900kw)  
**Generators:** 2\* 28kW Kohler

**Fuel Capacity:** 60,000  
**Fresh Water Capacity:** 7,000L

**Other Specification:**

**1 large suite high fashion with Jacuzzi for the Owner**

**1 large suite high fashion for the VIP Guest**

**2 VIP Cabin very luxury decoration**

**All the bedrooms are equipped with large TV and Pioneer HIFI**

**1 large captain suite very well equipped (Control of the Wheel house with sensor)**

**4 twin Cabin for the crew with a large mess and 2 bathroom.**

**2 large dinning high luxury style room for 12 guest**

**2 large comfortable Salon**

**1 entertainment large room (Cinema) with the best audio and video brands**

**2 large exterior Salon with luxury sofas**

**1 comfortable luxury Office for the owner**

**1 large kitchen for large reserve and 30 person cooking**

**1 large laundry**

**1 high tech wheel house with Automatic pilot, system Arpa, antipiracy system (Electronic flash) and military sensors**

**1 Large FastTender (Force 6) for 12 persons + 2 Jet Ski Kawasaki**

**1 light helicopter + one little sailboat.**

**1 parachute and 12 complete Diving clothes**

**Options**

**Porthault bed sets and table tops**

**Versace Curtains**

**Dior plates**

**Artwork**

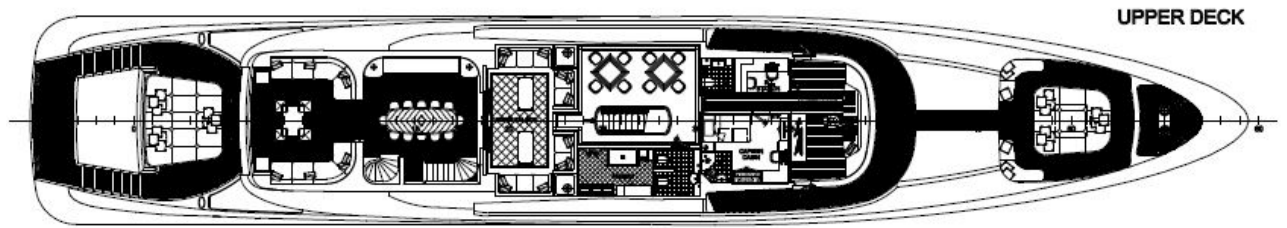

UPPER DECK

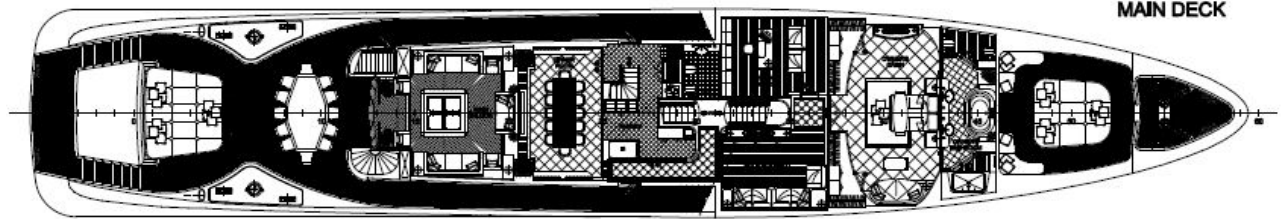

MAIN DECK

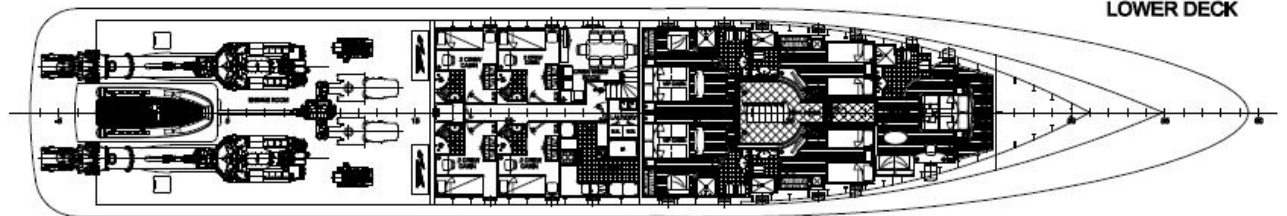

LOWER DECK





*Sussurro* not only goes fast but turns on a dime as well, courtesy of her deep-vee hull. The business end of the boat shows the Lipp buckets, trim tabs and centerline jet. Below, the high-tech helm.

## *Propulsion System*



## *Guest Room*



## *Study Room*

*Navigation, Communication, Entertainment*

## **Navigation**

### **Navigation radars**

Sperry Marine VisionMaster FT radar set in kit format for console integration including:

One radar VisionMaster FT250 X band, including:

- 8 Ft antenna X band white color
- Turning unit white color with transceiver 25 kw X band and performance monitor
- Processor CAT2 RADAR (ARPA) in kit format with tracker ball, keyboard and usb memory
- LCD flat display TFT 21" inch with integration kit

One radar VisionMaster FT250 S band, including:

- 12 Ft antenna S band white color
- Turning unit white color with transceiver 30 kw S band and performance monitor
- Processor CAT2 RADAR (ARPA) in kit format with tracker ball, keyboard and usb memory
- LCD flat display TFT 21" inch with integration kit

### **ECDIS**

Sperry Marine VisionMaster FT ECDIS including:

#### **Main ECDIS Station**

In kit format for integration in bridge console

- LCD flat display TFT 19"
- Computer including:
  - DVD reader
  - Trackball for bridge integration
  - Keyboard for bridge integration
- Sperry Marine software ECDIS VMS Vision Master FT (with radar overlay option)
- Interfaces for:
  - Radar 1 X (targets, navlines, position/route)
  - Radar 2 S (targets, navlines, position/route)



- Gyrocompas Navigat X
- DGPS 1
- DGPS 2
- AIS
- Echo sounder (depth)
- Wind speed (speed & direction)
- Auto Pilot NAVIPILOT 4000 (XTE)
- Use of the following charts (charts not included):
  - ARCS rasterscan charts
  - ECDIS DX90/S57
  - C-MAP
  - Primar (S63 encrypted S57)
- UPS

This set does not prevent the yacht to have and use paper charts.

### **Gyrocompas system**

Gyrocompas and repeaters from Sperry Marine including:

- One master compas NAVIGAT X Mk2 for power 24 Vdc /220 Vac (double power supply)
- One bridge repeater type 360/10 (192 x 192 mm) for bridge integration
- One repeater for machine room UDR type waterproof
- One Rate Of Turn (ROT) indicator
- One heading repeater for flybridge

### **Magnetic compass**

Magnetic compass system from Sperry Marine (C PLATH) :

- Magnetic compass VENUS type for bridge integration
- Electronic compass for connection to Auto Pilot (heading backup)

### **GPS/DGPS**

Ensemble GPS/DGPS JRC :

- Two "Control and Display Unit" (CDU) with LCD for console integration
- One GPS antenna
- One DGPS antenna
- Cable sets antenna-CDU, length 40 m
- NMEA distribution box, 2 ins, 8 outs for navigation systems
- Power supply 220/24 Vcc

### **Surface speed log**

Speed log for surface longitudinal speed measurements from Sperry Marine type NAVIKNOT 350 E including:

- One « Control and Display Unit » with LCD, for bridge integration
- One « Electronic unit »
- One « pre-amplifier » for transducer
- One transducer type EM with 20 m cable for assembling on fiber glass hull
- Installation accessories
- One Fly bridge repeater

(caution :max distance between pre-amplifier and transducer is 20 m, which is cable length. The shipyard is to realize the transducer installation)

### **Wind speed and direction**

Weather set for measurements and display of the following information:

- Wind speed and wind direction,
- Water temperature,
- Pressure
- Humidity

### **Echo sounder**

One JRC echo sounder including:

- One control and command unit with display
- One 200 khz transducer
- One fly bridge repeater with depth alarm

### **Auto pilot**

Auto pilot set Sperry Marine type NAVIPILOT 4000 Digital Adaptive Autopilot including:

- one « Control and Display Unit » with LCD display for bridge integration,
- one auto pilot repeater for fly bridge
- one « Steering Control Interface Unit » (type 74707 & 20042) with interfaces for connection to solenoids 24 Vcc,
- Converter 380 / 24 Vcc (type 60208) to supply the AP from AC Main

### **AIS**

one AIS class B JRC (Tx and Rx).

### **SSAS**

SSAS set « Thrane and Thrane », SAILOR 6120 :

- one SAILOR 3027 SSA mini-C SSAS Terminal
- one SAILOR 6194 Terminal Control Unit
- three SSAS Alert/Test Buttons for bridge, captain cabin and officer rooms

## **Internal communication**

### **Interphone**

One interphone system for hand free use, including handsets for :

- Bridge,
- Fly bridge
- Aft
- Fore
- Kitchen
- Crew

The interphone set is connected to internal/external loudspeakers for music distribution on board ship.

### **Telephone set**

One IP telephone set with:

- Switch board for connection to :
  - External ashore lines
  - 3G modem
  - Fleet broadband
  - VSAT VOIP
- 12 internal telephones
- 4 DECT telephones hand free
- 1 DECT radio Tx/Rx
- One fax machine

### **Wifi**

2 wifi radio Tx/Rx to cover whole yacht:

- Internal radio wifi
- External radio wifi

## **External communication**

### **GMDSS A3**

Complete GMDSS A3 area.

#### **HF radio set**

HF radio Thrane&Thrane type System 6000 MF/HF 150 W, power 220 Vac et 24 Vdc, including :

- Control unit SAILOR 6301
- Tactical display
- MF/HF Control Unit 24 Vdc type 6301 with DSC
- Antenna coupler type ATU 6381
- Tx Rx SSB MF/HF 150 W – 1 ASN canal
- Power 220 Vac – 24 Vdc type PS4655
- Batteries charger with batteries
- Antenna MF/HF
- Antenna MF/HF Rx
- Set of cables

#### **VHF radio set**

VHF Thrane&Thrane, power supply 24/12 Vdc:

- 2 x VHF DSC type 6222 avec combiné
- Power supply 220 Vac / 24 Vdc type N163S
- VHF antenna
- Set of cables

### **MINI C GMDSS**

SAILOR Standard C type 3027 C with:

- Transceiver within antenna 3027 C
- Display / Terminal with alarm button 6006
- Keyboard
- Set of cables

### **GMDSS VHF portable handsets**

VHF portable GMDSS – 2 W, with:

- 3 x portable VHF 2 W SP 3520 B
- Lithium battery
- Li-ion battery rechargeable
- Battery charger

NAVTEX

NAVTEX JRC :

- NAVTEX receiver dual frequency
- Display unit
- Antenna
- Antenna cable

EPIRB & SART

- EPIRB JOTRON 406 Mhz class 1 hydrostatic launching
- SART 9 Ghz JOTRON with bulkhead assembly

VHF Marine

VHF Thrane&Thrane :

- VHF DSC type 6222
- Remote handsets (bridge and fly bridge)
- Power supply 220 Vca/ 24 Vdc type N163S
- VHF antenna
- cable set

**Modem 3G**

- Modem POSSIO SVEA II
- external antenna
- PS 220 vac / 12 Vdc

**VSAT**

VSAT KVH for voice and data (high baudrate internet access 256 Kbits) with :

- One antenna M9 89 cms
- One modem
- One switch

**Video cameras**

AXIS cameras set with:

- Control station
  - PC1 HD 800 Go wIP card and AXIS Camera Station OS
  - Display 21" with control and command unit
- video server for recording
- 6 external cameras waterproof



- 5 internal cameras
- Switch 12 Ports PoE

### **Entertainment / Television**

The system proposed like in hotel give the possibility to select on each TV up to 24 channels from satellite or digital network.

#### **TV SAT antenna**

TV KVH TracVision M9

- bande Ku (10,7GHz to 12,75 GHz)
- simultaneous reception of TV and radio channels
- Polarisation horizontal
- 82 cms – 43 dBW
- Format DVB-S

#### **TNT Digital**

One marine antenna for reception of digital radio TV frequencies and channels.

#### **Tuner CD/DVD**

Two readers for the standard format like: DVD vidéo, DVD-RAM, DVD-RW/+RW, DVD-R/+R. An internal program can be broadcasted on board.

#### **Audio tuner**

Radio tuner to broadcast radio programs on board.

#### **IPTV Streamer**

IP broadcast is realized via an « hospitality » system “ANEVIA FLAMINGO 660”.

This system can use:

- Two DVB-S (satellite KVH),
- One DVB-T (Digital TV and radio),
- Two inputs S-Video for CD/DVD readers,
- Audio input

From each inputs, 12 chaneln can be broadcasted. Program is in relation with satellite in use and programs accessible.

**Television et Set Top Box**

Six TV stations are positioned on board. It is 66 cms (26 inches) TV, with HDMI plug to connect one « set top box ». the remote associated to the “set top box” is use to select the program broadcasted.

Disclaimer

\*Every attempt has been made to give accurate information, but performance and range figures are estimates given as a guide only. Dirt or growth on the hull, tuning of the engines, size, make of engines fitted, damage to propellers, the temperature of the air and water, the weight of fuel, water, stores, number of people, propeller pitch, quality of fuel and other matters, can all affect the boat's performance and range. For these and other reasons we can give no performance, range or other guarantees, and neither such guarantees nor anything contained herein constitutes an offer of contract or any representation or agreement, or may otherwise be relied upon. The photographs and artist's impressions in this document are of existing models in the UFMG range. There may be items shown in these photographs and artist's impressions that are not included in the standard inventory of the models shown. Actual specifications will be provided when a sales order or enquiry is placed with us.